

A RELIABLE PARTNER YOU CAN TRUST

[sales@oilongvalve.com](mailto:sales@oilongvalve.com)



## SHANGHAI OILONG VALVE

ADD: Room 716, Building B, No.399 Zhongren Road,  
Shanghai, China. P.C 201802

TEL: +86 21 61362291

EMAIL: [sales@oilongvalve.com](mailto:sales@oilongvalve.com) | [oilongvalve@gmail.com](mailto:oilongvalve@gmail.com)

WEBSITE: [www.oilongvalve.com](http://www.oilongvalve.com)

Scan WhatsApp for valve inquiry



Profession | Reliability | Efficiency



Floating / Trunnion Ball Valves

## STEEL BALL VALVES

Design Standard: API 6D/ASME B16.34

Size Range: 1/2" ~ 36"

Pressure Class: 150 ~ 2500

End Connection: BW / Flanged



[www.oilongvalve.com](http://www.oilongvalve.com)

**Floating Ball Valve**



Design Features:

- ✧ Anti-static Design, Firesafe Design, Blow-out Proof Stem
- ✧ One-piece or Two-piece Body, Floating Ball
- ✧ Locking Device, ISO Mounting Pad upon Request

DESIGN AND MANUFACTURING STANDARDS	
DESIGN:	ASME B16.34, API 608, BS 5351, ISO 17292, API 6D
FACE TO FACE:	ASME B16.10, API 6D
END FLANGE:	ASME B16.5
BW ENDS:	ASME B16.25
FIRE SAFE:	API 607, API 6FA
TEST:	API 598, API 6D

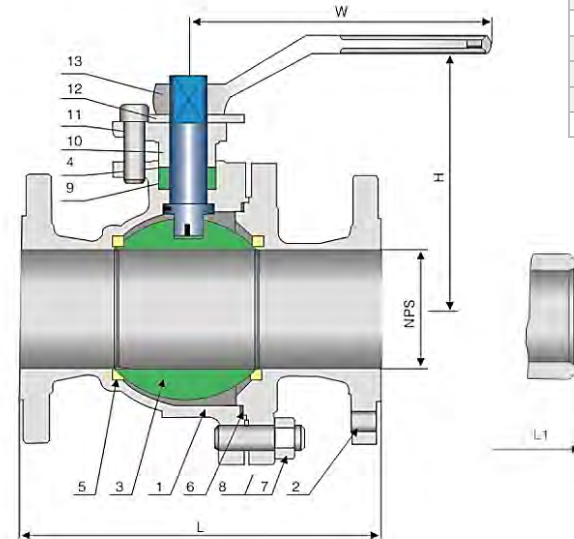

No	Part Name	Carbon Steel Standard	Stainless Steel 18Cr-9Ni-2Mo	Carbon Steel Low Temp
1	Body	A216-WCB	A351-CF8M	A352-LCB
2	Bonnet	A216-WCB	A351-CF8M	A352-LCB
3	Ball	A182-F304 A105+ENP	A182-F316	A182-F304
4	Stem	A276-304	A276-316	A276-304
5	Seat Ring	R.PTFE	R.PTFE	R.PTFE
6	Bonnet Gasket	Graphite+304	PTFE	Graphite+304
7	Stud	A193-B7	A193-B8	A320-L7
8	Nut	A194-2H	A194-8	A194-4
9	Packing	PTFE	PTFE	PTFE
10	Gland Flange	A216-WCB	A351-CF8M	A352-LCB
11	Gland Bolt	A193-B7	A193-B8	A193-B7
12	Stop Plate	Carbon Steel	Carbon Steel+Zn	Carbon Steel
13	Handle	Carbon Steel	Carbon Steel	Carbon Steel

Note: Other materials available on request.

**CAST STEEL FLOATING BALL VALVE**
**CLASS 150 Cast Steel Floating Ball Valve**

NPS DN	1/2 15	3/4 20	1 25	1½ 40	2 50	2½ 65	3 80	4 100	6 150	8 200	10 250	12 300	Unit
L (RF)	4.25	4.62	5.00	6.50	7.00	7.50	8.00	9.00	15.50	18.00	21.00	24.00	in
	108	117	127	165	178	190	203	229	394	457	533	610	mm
L1 (BW)	5.50	6.00	6.50	7.50	8.50	9.50	11.12	12.00	18.00	20.50	22.00	25.00	in
	140	152	165	190	216	241	283	305	457	521	559	635	mm
H	2.12	2.12	2.75	3.50	4.12	6.12	7.25	8.00	10.00	11.00	13.50	16.50	in
	55	55	70	90	105	155	185	205	255	280	345	420	mm
W	5	5	6	8	14	16	20	20	24	32	32	32	in
	130	130	160	200	350	400	500	500	600	800	800	800	mm
wt(kg)	2.3	3	4.5	7	9.5	15	19	33	93	160	200	352	RF

**CLASS 300 Cast Steel Floating Ball Valve**

NPS DN	1/2 15	3/4 20	1 25	1½ 40	2 50	2½ 65	3 80	4 100	6 150	8 200	10 250	12 300	Unit
L (RF)	4.25	4.62	5.00	6.50	7.00	7.50	8.00	9.00	15.50	18.00	21.00	24.00	in
	108	117	127	165	178	190	203	229	394	457	533	610	mm
L1 (BW)	5.50	6.00	6.50	7.50	8.50	9.50	11.12	12.00	15.88	19.75	22.38	25.50	in
	140	152	165	190	216	241	283	305	403	502	568	648	mm
H	2.12	2.12	2.75	3.50	4.12	6.12	7.25	8.00	10.00	11.00	13.50	16.50	in
	55	55	70	90	105	153	187	206	255	280	345	420	mm
W	5	5	6	8	14	16	20	20	24	32	32	32	in
	130	130	160	200	350	400	500	500	600	800	800	800	mm
wt(kg)	2.5	3.5	5.5	10.5	14.5	23.5	30	55	118	180	250	415	RF

**CLASS 600 Cast Steel Floating Ball Valve**

NPS DN	1/2 15	3/4 20	1 25	1½ 40	2 50	2½ 65	3 80	4 100	6 150	8 200	10 250	12 300	Unit
L (RF/BW)	6.50	7.50	8.50	9.50	11.50	13.00	14.00	17.00	22.00	—	—	—	in
	165	190	216	241	292	330	356	432	559	—	—	—	mm
L1 (RTJ)	—	—	—	—	11.62	13.12	14.12	17.12	22.12	—	—	—	in
	—	—	—	—	295	333	359	435	562	—	—	—	mm
H	2.38	2.38	3.00	4.00	4.75	6.88	8.38	9.25	11.38	—	—	—	in
	61.5	61.5	78	101	120	174	212	234	289	—	—	—	mm
W	5	6	8	14	16	20	24	24	32	—	—	—	in
	130	160	200	350	400	500	600	600	800	—	—	—	mm
wt(kg)	3.3	4.5	7.2	13.5	19	31	39	71	153	—	—	—	RF/RTJ

Note: All related data and parameters are for reference only and are subject to change without notice.

**DESIGN AND MANUFACTURING STANDARDS**

DESIGN:	ASME B16.34, API 608, BS 5351, ISO 17292, API 6D
FACE TO FACE:	ASME B16.10, API 6D
END FLANGE:	ASME B16.5
BW ENDS:	ASME B16.25
FIRE SAFE:	API 607, API 6FA
TEST:	API 598, API 6D

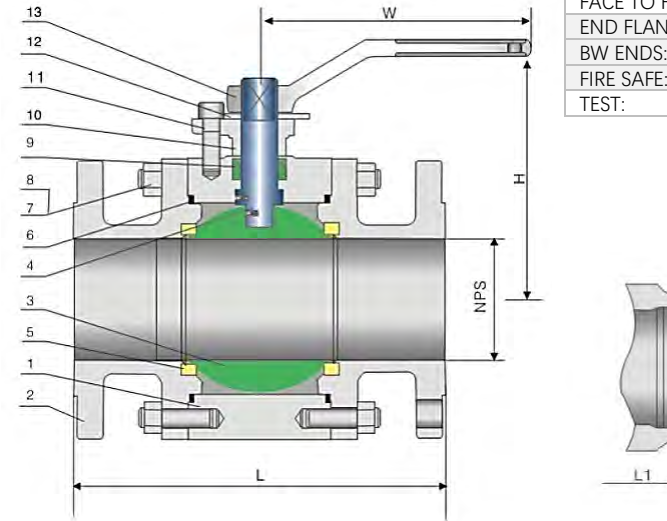

No	Part Name	Carbon Steel Standard	Stainless Steel 18Cr-9Ni-2Mo	Carbon Steel Low Temp
1	Body	A105	A182-F316	A350-LF2
2	Bonnet	A105	A182-F316	A350-LF2
3	Ball	A182-F304 A105+ENP	A182-F316	A182-F304
4	Stem	A276-304	A276-316	A276-304
5	Seat Ring	R.PTFE	R.PTFE	R.PTFE
6	Bonnet Gasket	Graphite+304	PTFE	Graphite+304
7	Stud	A193-B7	A193-B8	A320-L7
8	Nut	A194-2H	A194-8	A194-4
9	Packing	PTFE	PTFE	PTFE
10	Gland Flange	A105	A182-F316	A350-LF2
11	Gland Bolt	A193-B7	A193-B8	A193-B7
12	Stop Plate	Carbon Steel	Carbon Steel+Zn	Carbon Steel
13	Handle	Carbon Steel	Carbon Steel	Carbon Steel

Note: Other materials available on request.

**FORGED STEEL FLOATING BALL VALVE**
**CLASS 150 Forged Steel Floating Ball Valve**

NPS DN	1/2 15	3/4 20	1 25	1½ 40	2 50	2½ 65	3 80	4 100	6 150	8 200	10 250	12 300	Unit
L (RF)	4.25	4.62	5	6.50	7	7.50	8	9	15.50	18	21	24	in
	108	117	127	165	178	190	203	229	394	457	533	610	mm
L1 (BW)	5.50	6	6.50	7.50	8.50	9.50	11.12	12	18	20.50	22	25	in
	140	152	165	190	216	241	283	305	457	521	559	635	mm
H	2.12	2.12	2.50	3.38	4	6	7	9.25	9.88	11	12.62	15.38	in
	55	55	65	85	100	150	180	235	250	280	320	390	mm
W	8	8	12	12	16	16	24	24	24	24	32	32	in
	200	200	300	300	400	400	600	600	600	600	800	800	mm
wt(kg)	3.10	4.10	6	9.50	12.80	20	26	45	126	216	270	378	RF

**CLASS 300 Forged Steel Floating Ball Valve**

NPS DN	1/2 15	3/4 20	1 25	1½ 40	2 50	2½ 65	3 80	4 100	6 150	8 200	10 250	12 300	Unit
L (RF)	5.5	6	6.5	7.5	8.5	9.5	11.12	12	15.88	19.75	22.38	25.5	in
	140	152	165	190	216	241	283	305	403	502	568	648	mm
L1 (BW)	5.5	6	6.5	7.5	8.5	9.5	11.12	12	18	20.5	22	25	in
	140	152	165	190	216	241	283	305	457	521	559	635	mm
H	2.12	2.12	2.5	3.38	16	16	24	24	9.88	11	12.62	15.38	in
	55	55	65	85	400	400	600	600	250	280	320	390	mm
W	8	8	12	12	10	12	14	19	24	24	32	32	in
	200	200	300	300	250	300	350	480	600	600	800	800	mm
Wt(kg)	3.5	4.6	6.7	10.5	14.5	22	29	50	141	242	302	423	RF

**CLASS 600 Forged Steel Floating Ball Valve**

NPS DN	1/2 15	3/4 20	1 25	1½ 40	2 50	2½ 65	3 80	4 100	6 150	8 200	10 250	12 300	Unit
L (RF/BW)	6.50	7.50	8.50	9.50	11.50	13.00	14.00	17.00	22.00	—	—	—	in
	165	190	216	241	292	330	356	432	559	—	—	—	mm
L1 (RTJ)	—	—	—	—	11.62	13.12	14.12	17.12	22.12	—	—	—	in
	—	—	—	—	295	333	359	435	562	—	—	—	mm
H	2.25	2.25	2.62	3.50	4.12	6.25	7.50	9.75	10.38	—	—	—	in
	58	58	68	89	105	158	190	247	262	—	—	—	mm
W	8	12	12	16	16	24	24	24	32	—	—	—	in
	200	300	300	400	400	600	600	600	800	—	—	—	mm
Wt(kg)	10	12	14	16	22	27	42	78	172	—	—	—	RF/RTJ

Note: All related data and parameters are for reference only and are subject to change without notice.

**Trunnion Ball Valve**

## Design Features:

- ✦ Full Bore or Reduced Bore, Double Block and Bleed
- ✦ Anti-static Design, Firesafe Design, Blow-out Proof Stem
- ✦ Two-piece or Three-piece Body, Trunnion Mounted Ball
- ✦ Duplex SS overlay, ISO Mounting Pad upon Request

DESIGN AND MANUFACTURING STANDARDS	
DESIGN:	API 6D, API 608
FACE TO FACE:	ASME B16.10, API 6D
END FLANGE:	ASME B16.5
BW ENDS:	ASME B16.25
FIRE SAFE:	API 607, API 6FA
TEST:	API 598, API 6D

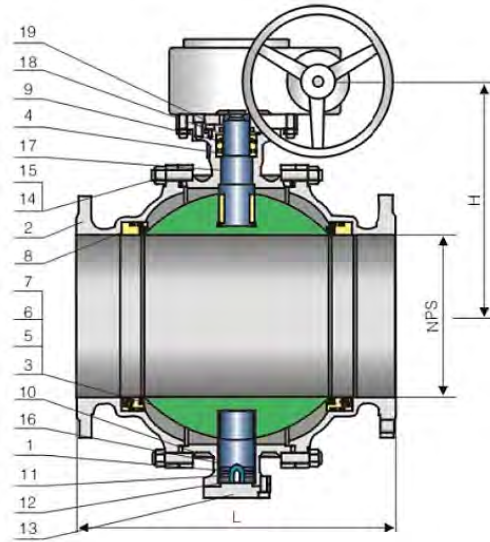
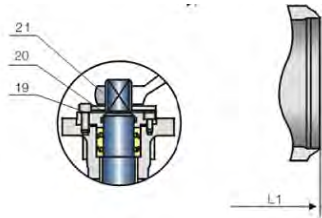

No	Part Name	Carbon Steel Standard	Stainless Steel 18Cr-9Ni-2Mo	Carbon Steel Low Temp
1	Body	A216-WCB / A105	A351-CF8M/ A182-316	A352-LCB / A350-LF2
2	Bonnet	A216-WCB / A105	A351-CF8M/ A182-316	A352-LCB / A350-LF2
3	Ball	A182-F304	A182-F316	A182-F304
4	Stem	A276-304	A276-316	A276-304
5	Seat	A105+ENP	A182-F316	A350-LF2+ENP
6	Seat Insert	Glass Filled PTFE	Glass Filled PTFE	Glass Filled PTFE
7	Seat Spring	A313-304	Inconel X-750	A313-304
8	Seat O-Ring	NBR	Viton	Viton
9	Stem O-Ring	NBR	Viton	Viton
10	Bonnet Gasket	Graphite+304	Graphite+316	Graphite+304
11	Bonnet O-Ring	NBR	Viton	Viton
12	Antistatic Spring	A313-304	A313-316	A313-304
13	Lower Cover	A216-WCB	A182-F316	A182-F304
14	Bonnet Stud	A193-B7	A193-B8	A320-L7
15	Bonnet Stud Nut	A194-2H	A194-8	A194-4
16	Trunnion	A276-304	A276-316	A276-304
17	Trunnion Bearing	304+PTFE	316+PTFE	304+PTFE
18	Gland Flange	A216-WCB / A105	A351-CF8M/ A182-316	A352-LCB / A350-LF2
19	Gland Bolt	A193-B7	A193-B8	A193-B7
20	Stop Plate	Carbon Steel	Carbon Steel+Zn	Carbon Steel
21	Handle	Carbon Steel	Carbon Steel	Carbon Steel

**CLASS 150 Cast Steel Trunnion Ball Valve**

NPS (in)		2	2½	3	4	6	8	10	12	14	16	18	20	24	30	32	36
DN (mm)		50	65	80	100	150	200	250	300	350	400	450	500	600	750	800	900
L (RF)	in	7	7.50	8	9	15.50	18	21	24	27	30	34	36	42	51	54	60
	mm	178	190	203	229	394	457	533	610	686	762	864	914	1067	1295	1372	1524
L1 (BW)	in	8.50	9.50	11.12	12	18	20.50	22	25	30	33	36	39	45	55	60	68
	mm	216	241	283	305	457	521	559	635	762	838	914	991	1143	1397	1524	1727
H	in	7	7.50	8.25	9.25	20.88	24.62	25.62	30.75	31	36.25	38.25	43.38	45.25	64.12	70.88	80.75
	mm	177	190	210	235	530	625	650	780	790	920	970	1100	1150	1630	1840	2050
W	in	14	16	20	20	24	24	24	24	32	32	32	32	32	32	32	32
	mm	350	400	500	500	600	600	600	600	800	800	800	800	800	800	800	800
wt(kg)	RF	15	21	30	42	120	205	322	520	776	965	1280	1605	2610	4070	5940	6670

Note: All related data and parameters are for reference only and are subject to change without notice.

**CLASS 300 Cast Steel Trunnion Ball Valve**

NPS (in)		2	2½	3	4	6	8	10	12	14	16	18	20	24	30	32	36
DN (mm)		50	65	80	100	150	200	250	300	350	400	450	500	600	750	800	900
L (RF)	in	8.50	9.50	11.12	12.00	15.88	19.75	22.38	25.50	30.00	33.00	36.00	39.00	45.00	55.00	60.00	-
	mm	216	241	283	305	403	502	568	648	762	838	914	991	1143	1397	1524	-
L1 (BW)	in	8.50	9.50	11.12	12.00	18.00	20.50	22.00	25.00	30.00	33.00	36.00	39.00	45.00	55.00	60.00	-
	mm	216	241	283	305	403	521	559	635	762	838	914	991	1143	1397	1524	-
H	in	7.00	7.50	8.25	9.25	20.88	24.62	25.62	30.75	31.00	36.25	38.25	43.38	45.25	64.12	70.88	-
	mm	177	190	210	235	530	625	650	780	790	920	970	1100	1150	1630	1800	-
W	in	14	16	20	20	24	24	24	24	32	32	32	32	32	32	32	-
	mm	350	400	500	500	600	600	600	600	800	800	800	800	800	800	800	-
wt(kg)	RF	20	25	36	55	168	255	430	633	940	1300	1542	1840	2930	5950	6760	-

**CLASS 600 Cast Steel Trunnion Ball Valve**

NPS (in)		2	2½	3	4	6	8	10	12	14	16	18	20	24	30	32	36
DN (mm)		50	65	80	100	150	200	250	300	350	400	450	500	600	750	800	900
L (RF)	in	11.5	13.0	14.0	17.0	22.0	26.0	31.0	33.0	35.0	39.0	43.0	47.0	55.0	-	-	-
	mm	292	330	356	432	559	660	787	838	889	991	1092	1194	1397	-	-	-
L1 (BW)	in	11.62	13.12	14.12	17.12	22.12	26.12	31.12	33.12	35.12	39.12	43.12	47.25	55.38	-	-	-
	mm	295	333	359	435	562	664	791	841	892	994	1095	1200	1407	-	-	-
H	in	7.12	7.62	8.5	9.5	21.25	25.0	26.12	31.12	31.88	36.38	38.75	44.5	46.62	-	-	-
	mm	180	193	215	241	540	635	665	790	810	925	985	1130	1185	-	-	-
W	in	14	16	20	20	24	24	24	24	32	32	32	32	32	-	-	-
	mm	350	400	500	500	600	600	600	600	800	800	800	800	800	-	-	-
wt(kg)	RF	26	35	58	91	210	337	540	810	1100	1530	2070	2600	3400	-	-	-

**CLASS 900 Cast Steel Trunnion Ball Valve**

NPS (in)		2	2½	3	4	6	8	10	12	14	16	18	20	24	30	32	36
DN (mm)		50	65	80	100	150	200	250	300	350	400	450	500	600	750	800	900
L (RF)	in	14.50	16.50	15.00	18.00	24.00	29.00	33.00	38.00	40.50	44.50	48.00	52.00	61.00	-	-	-
	mm	368	419	381	457	610	737	838	965	1029	1130	1219	1321	1549	-	-	-
L1 (BW)	in	14.62	16.62	15.12	18.12	24.12	29.12	33.12	38.12	40.88	44.88	48.50	52.50	61.75	-	-	-
	mm	371	422	384	460	613	740	841	968	1038	1140	1232	1334	1568	-	-	-
H	in	8.62	9.25	10.25	15.38	25.75	30.25	31.75	38.00	38.50	45.00	47.00	53.50	56.00	-	-	-
	mm	219	235	260	390	655	770	805	965	980	1145	1195	1360	1425	-	-	-
W	in	20	20	20	24	24	24	24	32	32	32	32	32	32	-	-	-
	mm	500	500	500	600	600	600	600	800	800	800	800	800	800	-	-	-
wt(kg)	RF	31	43	80	112	305	445	950	1440	1605	1765	2350	3535	5950	-	-	-

Note: All related data and parameters are for reference only and are subject to change without notice.

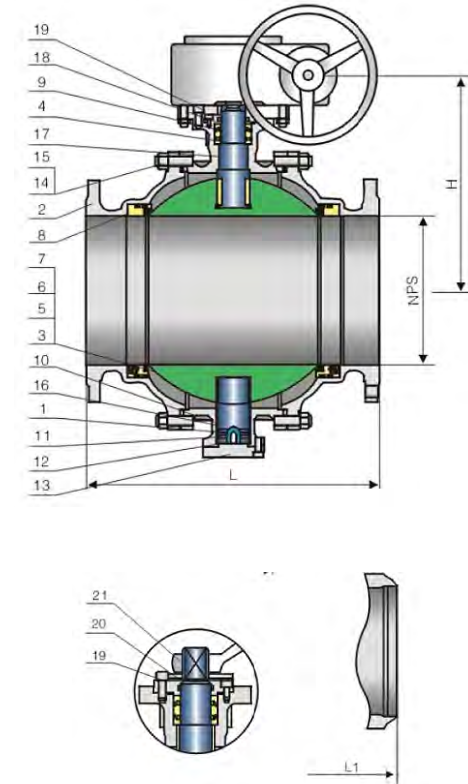

CLASS 1500 Cast Steel Trunnion Ball Valve											
NPS (in)		2	2½	3	4	6	8	10	12	14	16
DN (mm)		50	65	80	100	150	200	250	300	350	400
L/L1 (RF/ BW)	in	14.5	16.5	18.5	21.5	27.75	32.75	39	44.5	49.5	54.5
	mm	368	419	470	546	705	832	991	1130	1257	1384
L2	in	14.62	16.62	18.62	21.62	28	33.12	39.38	45.12	20.25	44.38
	mm	371	422	473	549	711	841	1000	1146	1276	1407
H	in	11.25	12	13.25	20	33.5	39.38	41.12	49.38	50	58.5
	mm	285	305	338	506	852	1000	1045	1255	1270	1485
W	in	20	20	24	24	24	32	32	32	32	32
	mm	500	500	600	600	600	800	800	800	800	800
wt(kg)	RF	55	67	86	153	368	640	1120	1675	2185	2955

CLASS 2500 Cast Steel Trunnion Ball Valve											
NPS (in)		2	2½	3	4	6	8	10	12	14	16
DN (mm)		50	65	80	100	150	200	250	300	350	400
L/L1 (RF/ BW)	in	17.75	20	22.75	26.5	36	40.25	50	56	-	-
	mm	451	508	578	673	914	1022	1270	1422	-	-
L1 (BW)	in	17.88	21.25	23	26.88	36.5	40.88	50.88	56.88	-	-
	mm	454	540	584	683	927	1038	1292	1445	-	-
H	in	12	12.88	14.25	21.25	35.88	42.12	44	53	-	-
	mm	304	327	362	540	911	1070	1120	1345	-	-
W	in	20	24	24	24	32	32	32	32	-	-
	mm	500	600	600	600	800	800	800	800	-	-
wt(kg)	RF	60	96	150	302	602	1012	1650	2565	-	-

Note: All related data and parameters are for reference only and are subject to change without notice.

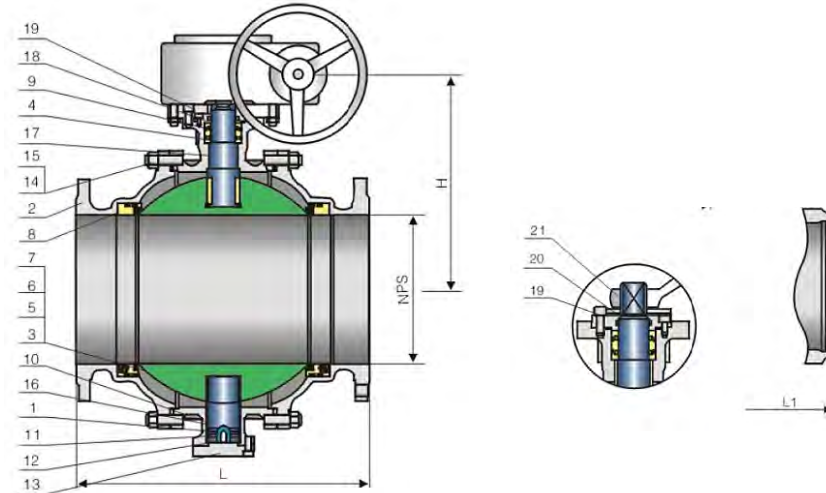

LEVER OPERATED  
REDUCED BORE  
TRUNNION MOUNTED BALL VALVE

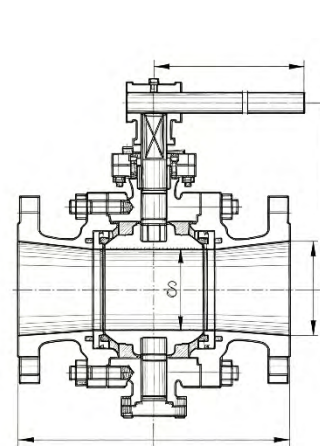

WORM GEAR OPERATED  
REDUCED BORE  
TRUNNION MOUNTED BALL VALVE

